

# Ant Yapı

Your Construction Partner

Together, let's create the buildings  
that shape our future.

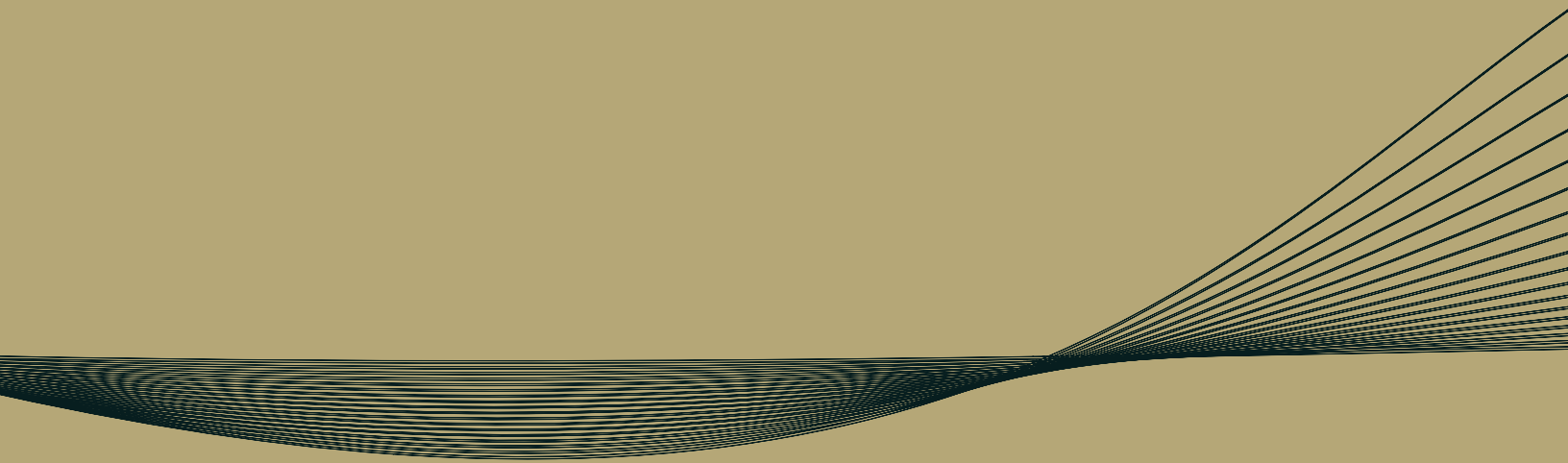

## **The Ant Yapi Story**

Since 1991, your construction partner for creating iconic hotel, resort, and residential environments:

Our journey has taken us to every corner of the globe. It began 30 years ago with the vision of becoming an industry leader through sustainable growth and development projects. We aspire to build more than high-quality "Structures."

At Ant Yapi, we are committed to creating lasting "Value" for our clients.

Ant Yapi projects span over six thousand square miles from the United Kingdom to the United States, and from Turkey to Russia. Our world-renown expertise in the construction industry is focused on hospitality, recreational, and residential projects.

Working alongside master architects, designers and engineers, Ant Yapi implements high concept architectural visions through the most advanced technology. Our client-centered approach moves us forward with passion and purpose to shape the future.

## **A Future Built on Timeless Values**

- Our mission is to provide services and effective solutions for our customers and partners with the best value for their investment.
- Our strategy is to succeed in becoming one of the world's leading construction management companies through our experience, hard work, and a thoughtful approach to business.
- Our passion is not just creating projects, but unique objects of modern architecture that will remain works of an art for centuries.
- Our goals are high quality construction delivered on time; long-term and trusting relationships with partners; the well-being of our customers, employees, suppliers; and care for the environment.

US Expansion | Steady Growth | Long-term Value

Our revenue exceeds \$930 million USD globally, with accelerated growth in the United States.

Measure our value by steady growth in annual contract values. Our reputation as a global industry leader in high concept, high quality construction continues to reach new heights with US expansion.

Total group revenue in 4 countries exceeds 930M USD\*

\*Including ICO

United States	United Kingdom	Turkey	Russia
180M USD revenue	44M USD revenue	80M USD revenue	626M USD revenue
5 Projects	5 Projects	6 Projects	49 Projects
Ant Yapi US Holding Corp.	Ant Yapi UK	Ant Yapi Konut	Ant Yapi
Ant Yapi New York	Ant Yapi Property Investment	Ant Site Yonetim Hizmetleri ve Turizm	Antteq
Ant Yapi Florida		Ant Aspat Yapi ve Turizm	Stellar Construction
		Ant Cevre Teknolojileri	Ant Development
		Yap Sanayi ve Ticaret	

Breaking new ground as a global construction industry leader.





# Ant Yapi

Transforming an iconic, historic  
New York City building

## The Crown Building Manhattan, New York

Ant Yapi US is proud of its first major project in the United States—the preservation and adaptive reuse of the historic 1921 Beaux-Arts Crown Building. The first high-rise building constructed in Manhattan, The Crown Building is the original home of The Museum of Modern Art located in the heart of the city’s tourist district. This beautiful landmark is reminiscent of old New York and will continue to grace the Manhattan cityscape with creative mixed-use redevelopment.

Spanning 25 floors, the majestic Crown Building is one of Manhattan’s most high-profile and visible renovation and expansion projects. The building’s transformation into a luxury hotel and residences include the construction of 22 condominium apartments, 83 hotel rooms, a grand lobby, a three-story day spa, indoor and outdoor pools, wrap-around terrace, gym, multiple restaurants with over 1000 square feet of outdoor dining, a jazz club in the cellar, and a subterranean wine cellar.

**INVESTOR/DEVELOPER:**  
OKO GROUP

**DESIGNER:**  
Jean-Michel Gathy

**CONSTRUCTION COST:**  
\$400,000,000

**LOCATION:**  
730 Fifth Avenue, New York, NY

**BUILDING SIZE:**  
25 stories, 2 cellars and a roof

**GROSS AREA:**  
346,597.915 sq feet

**HEIGHT:**  
413.39 ft

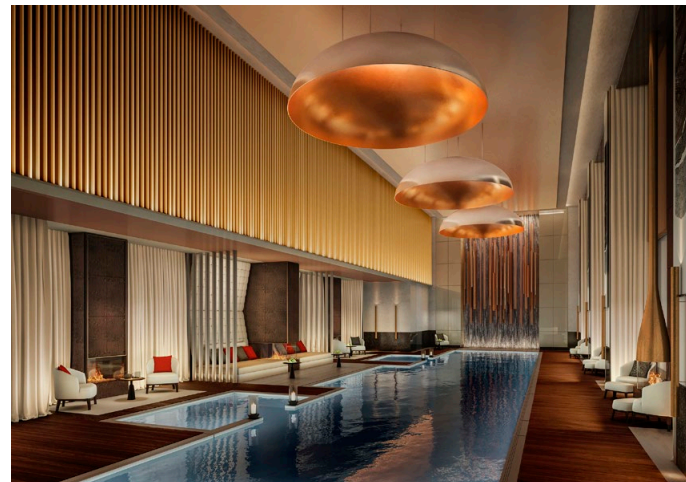
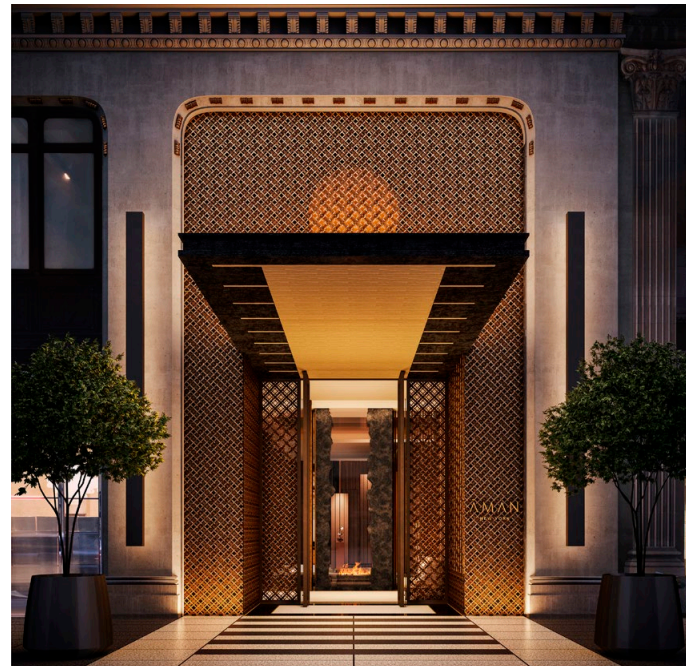



Ant Yapı

Dynamic waterfront community  
with breathtaking Manhattan views

Astoria West  
Queens, New York

Astoria West is a three-building residential development along the 2.5 acres of Queens waterfront with magnificent views of Manhattan. Spanning over 522 square feet across three structures, the complex includes 534 rental residences.

This major residential development will include studios, one- and two-bedroom units including a rooftop pool and lounge, a landscaped private interior courtyard and gardens, indoor- and outdoor co-working lounges, a fitness center, and a game room.

Located in the heart of Astoria’s art district, the residential development sits near Socrates Sculpture Park, The Noguchi Museum, and the Welling Court Mural Project. It is a three-minute walk to the Manhattan Ferry, and a short walk to the 30th Avenue subway station.

**INVESTOR:**  
Pioneer Group, Moscow, Russia  
**DEVELOPER:**  
Cape Advisors, New York, NY  
**ARCHITECT:**  
Fogarty-Finger Architecture,  
New York, NY  
**CONSTRUCTION COST:**  
\$155,000,000

**LOCATION:**  
30-77 Vernon Blvd., Astoria, NY  
**GROSS AREA:**  
509,994.076 sq feet  
**HEIGHT:**  
Mid-rise building, 7 Stories



Ant Yapı

An architectural jewel shimmering  
across Biscayne Bay

Missoni Baia Tower  
Miami, Florida

Missoni Baia captures the legendary fashion family’s joyful spirit, infusing the experience of the building with a relaxed sense of luxury. Spanning 200 feet of frontage on Biscayne Bay, Missoni Baia is a unique work of high-style design complimented by high performance construction. This visionary architectural masterpiece is influenced by Minimalist art and driven by forward-thinking engineering.

Missoni Baia offers a luxurious residential experience as distinctive as the uncompromising aesthetic of the Missoni brand. Inspired by a spirit of technical innovation and design excellence, designer Paris Forino, under the creative direction of Angela and Rosita Missoni, envisioned the tower’s 249 elegantly crafted one- to five-bedroom residences, furnishings, and artworks. The building offers expansive amenities including an Olympic-sized pool, a large and elegantly appointed spa—and a richly layered landscape and gardens.

**INVESTOR/DEVELOPER:**  
OKO GROUP  
**ARCHITECT:**  
Asymptote Architecture  
**CREATIVE DIRECTION:**  
Angela and Rosita Missoni  
**LANDSCAPE DESIGN:**  
Enzo Enea  
**CONSTRUCTION COST:**  
\$200,000,000  
**LOCATION:**  
Biscayne Bay East Edgewater, Florida  
**BUILDING SIZE:**  
57 stories, 200 linear feet of bayside frontage  
**GROSS AREA:**  
855,601.71 sq feet  
**HEIGHT:**  
650 ft

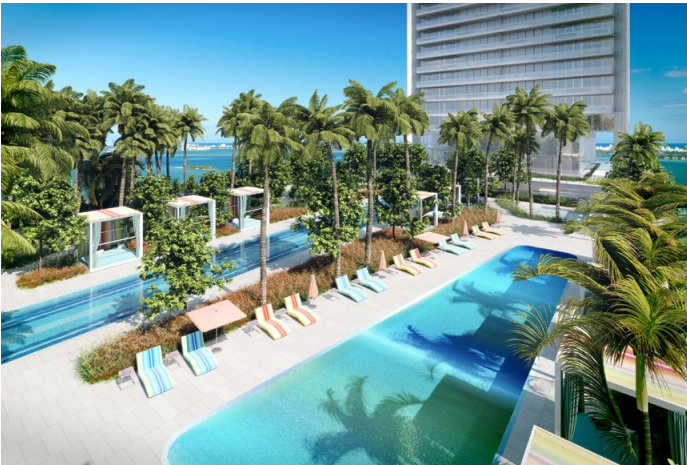



# Ant Yapı

Boldly rising above Miami’s financial center district

## 830 Brickell Plaza Miami, Florida

As the first freestanding Class A+ skyscraper to be built in over a decade, 830 Brickell Place brings a premium commercial offering to the center of Miami’s financial business district. Designed by internationally acclaimed Adrian Smith + Gordon Gill Architecture, the firm stands behind the Jeddah Tower and the Burj Khalifa, the tallest towers in the world. 830 Brickell stands apart as a premier example of future-forward, sustainable commercial building design, engineering and construction.

830 Brickell Plaza towers above Miami Beach with 55 floors of uninterrupted glass, illuminated day and night. With LEED Silver certification, this energy-efficient building blends sleek eco-conscious design with people-friendly amenities including Sky Lobby work and conference facilities, a full-service fitness center, rooftop bar and restaurant, EV charging stations, and 8 stories of covered parking spaces.

- INVESTOR:**  
OKO Group
- DEVELOPER:**  
OKO GROUP, Cain International
- ARCHITECT:**  
Adrian Smith + Gordon Gill Architecture
- CONSTRUCTION COST:**  
\$220,000,000
- LOCATION:**  
830 Brickell Plaza, Miami, Florida
- GROSS AREA:**  
892,000,000 sq feet
- HEIGHT:**  
750 ft
- GREEN FEATURES:**  
LEED Silver Certification, Energy-efficient building envelope



# Ant Yapı

Stunning Biscayne Bay luxury residences inspired by yacht design

## UNA Residences Miami, Florida

UNA is the first new condominium development to grace the Brickell Waterfront in over a decade. Inspired by classic yacht design and its bayfront setting, Una sets the standard for Brickell Waterfront living, with visionary design, inviting gardens and unrivaled views across Biscayne Bay.

Una offers 135 luxury condominium residences spanning 47 floors with floor-to-ceiling glass, expansive terraces, and an array of amenities, including three pools and private boat slips, and underground parking facilities. The stunning tower is recognizable by its smooth, light-metallic surface and striking silhouette that recalls the natural shape of a wave. UNA is just as dramatic up close as it is from afar. The modern curves are complemented by the richly landscaped gardens, while inside UNA there are striking views of the water at every turn.

- INVESTOR:**  
OKO Group
- DEVELOPER:**  
OKO Group, Cain International
- ARCHITECT:**  
Adrian Smith + Gordon Gill Architecture
- LANDSCAPE ARCHITECTURE:**  
Enea Landscape Architecture
- CONSTRUCTION COST:**  
\$170,000,000
- LOCATION:**  
Brickell Avenue, Miami Florida
- GROSS AREA:**  
414,150 sq feet
- HEIGHT:**  
47 Stories





Let's work together!

**NEW YORK OFFICE**

31-01 Vernon Blvd, Ste 2, Astoria, NY 11106

**FLORIDA OFFICE**

720 NE 27th Street, Miami, FL 33137



917.546.6916



info@antyapi.us



antyapi.us



ANT YAPI USA

# Ant Yapı

A decorative graphic consisting of numerous thin, parallel, wavy lines in a light beige color. These lines originate from the bottom left and fan out towards the right, creating a sense of motion and depth.